

## Replacing the Door Stop For the Front Side Door Replacing The Door Stop For The Front Side Door

**NOTE:** As the illustrations in this service information are used for different model years and/or models, some variation may occur. However, the essential information in the illustrations is always correct.

### Removing the door stop for the front side door

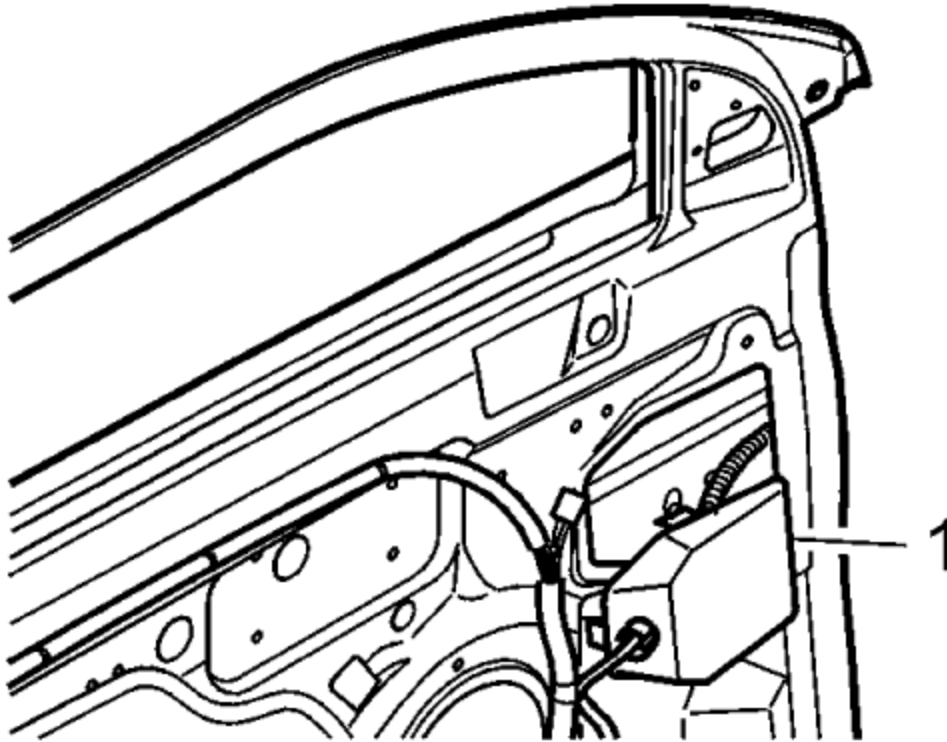

- The window must be closed.
- Remove the [door panel](#).
- Disconnect and move the front plastic cover (1) to one side.

**Remove:**

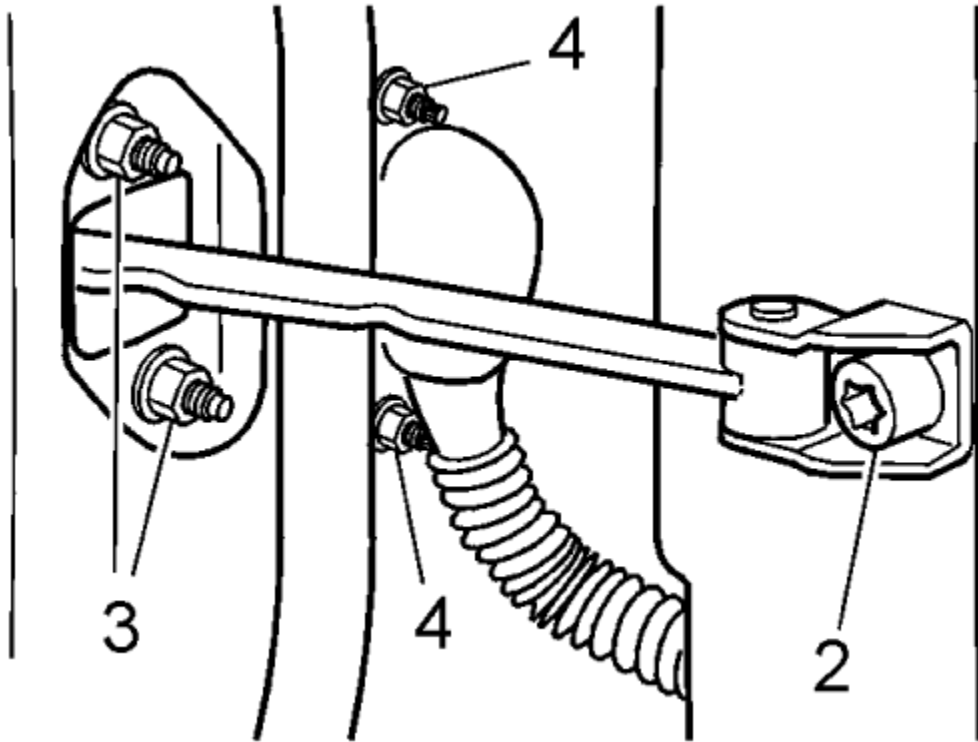

- one screw (2)
- two nuts (3)
- the two nuts (4).

**NOTE:** There is a cover over the screw (2) in some cars. This must be discarded and not replaced with a new one when replacing the door stop.

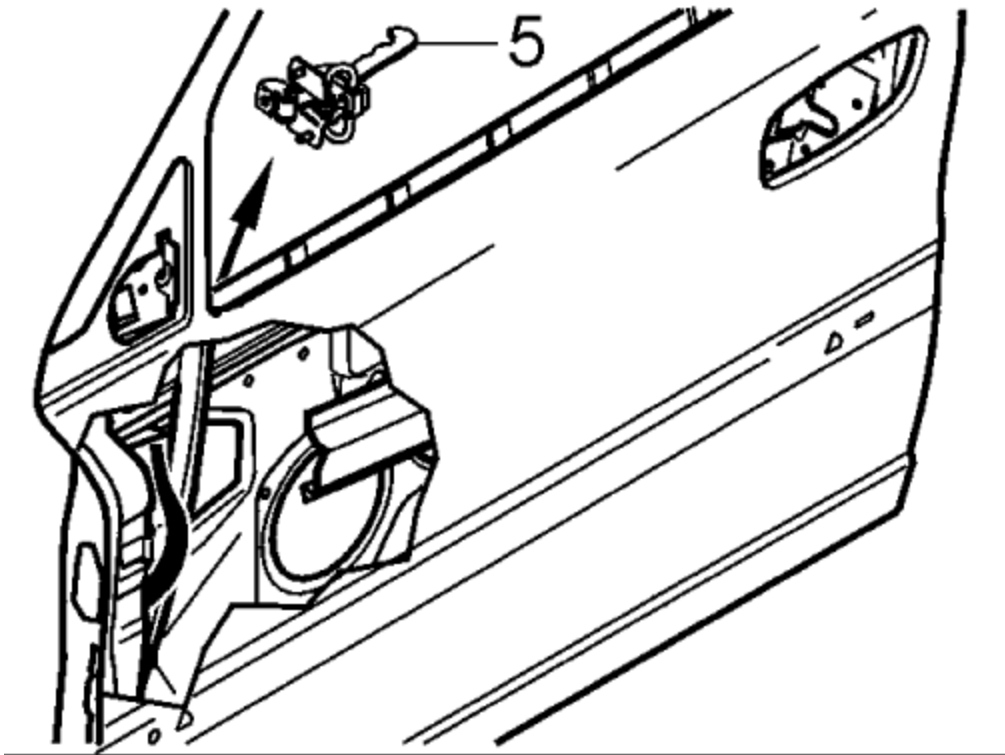

Twist the door stop carefully to remove it through the opening.

**NOTE:** It is tight past at front guide for the front window. Great care must be taken. It is easy to dent the panels.

## Installing the door stop for the front side door

Install:

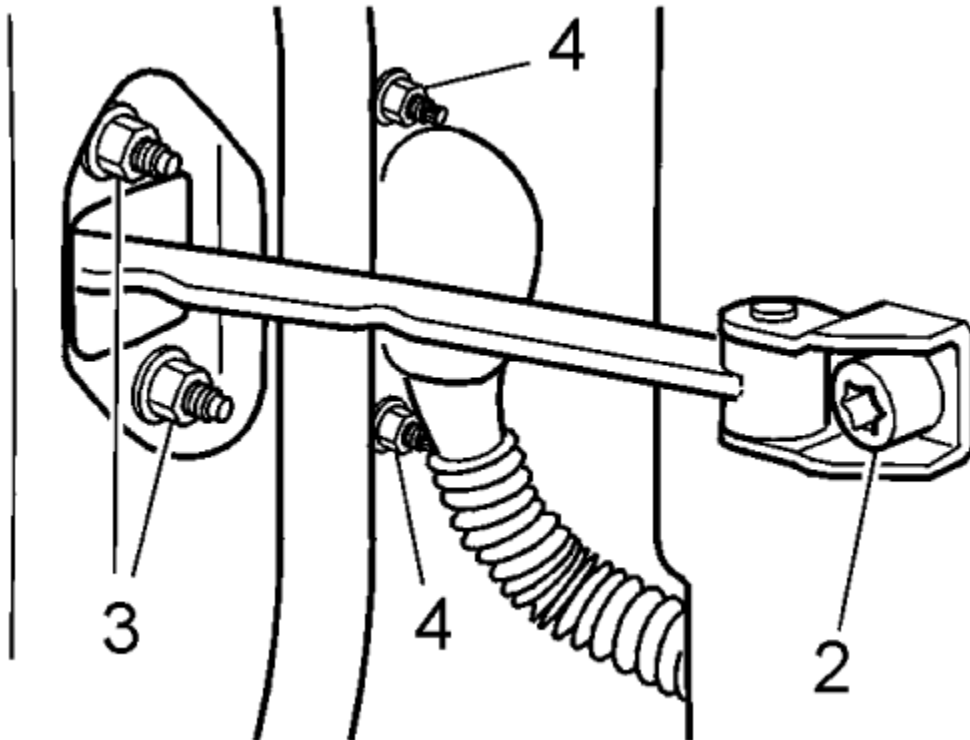

- the door stop
- the screw (2)
- the nuts (3)
- the nuts (4)
- the [door panel](#).
- the front plastic cover.

**NOTE:** Use new locking fluid or new screw in the screwed joint when replacing the door stop.

If using new locking fluid, remove the residue of the old locking fluid from the screw.

