

Section	Group	No.	Year	Month
8	89	0253	2001	12

Drag US, CA

Tow bar US, CA

Barre de remorquage US, CA

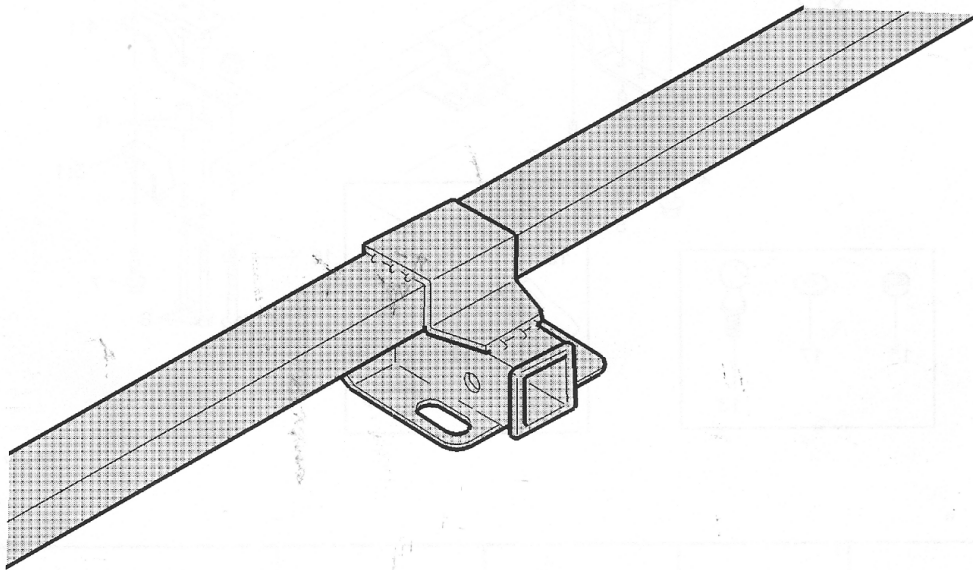

M8902423

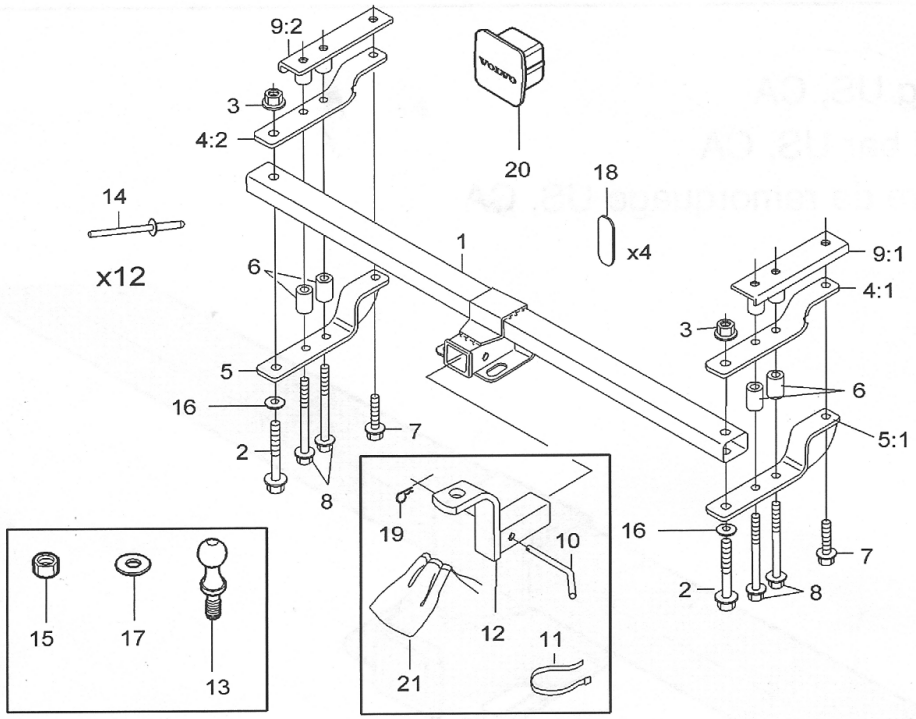

M8902867

Market	Car model	Part no#	Supplier no#	Checked according to
US, CA	V70	8682307	04- 116700	VESC V-5
US, CA	V70 XC	8682306	04- 116400	VESC V-5

Any comments on this publication? Please contact your nearest dealer.  
Thank you!

Publication no: MA 8682173, Issue: 2001-12
Comments:..... ..... ..... .....
From:.....
Address:.....

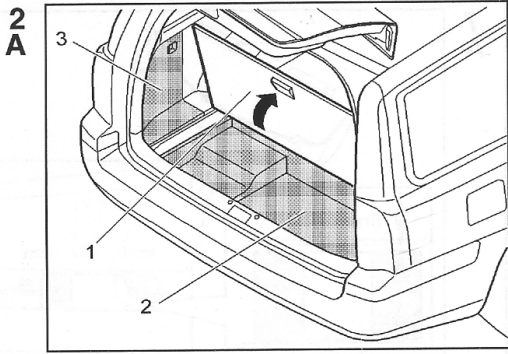

M8301410

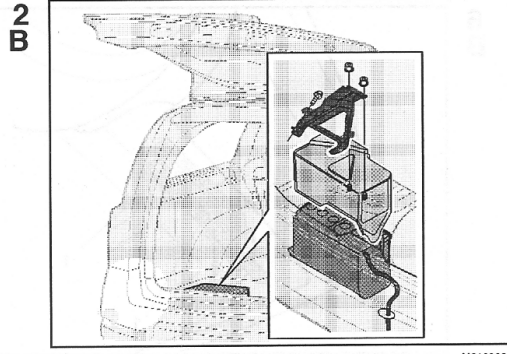

M3100090

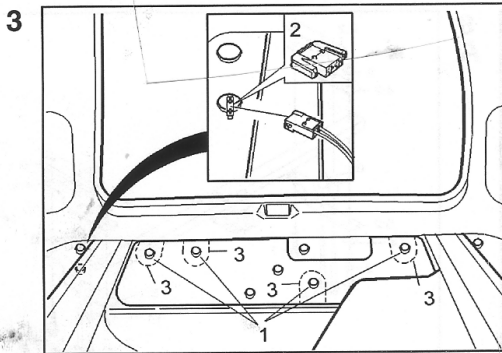

M8101064

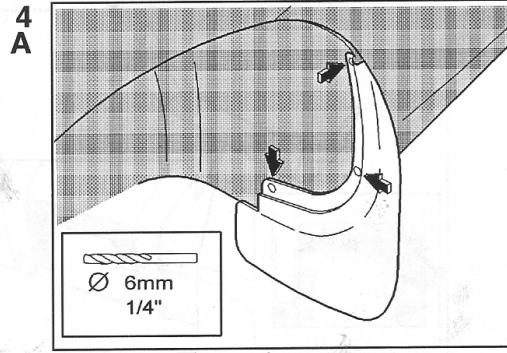

M8600488

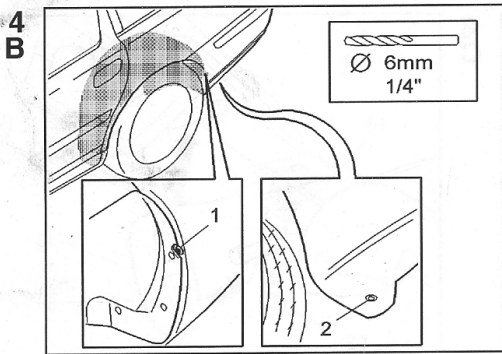

M8600489

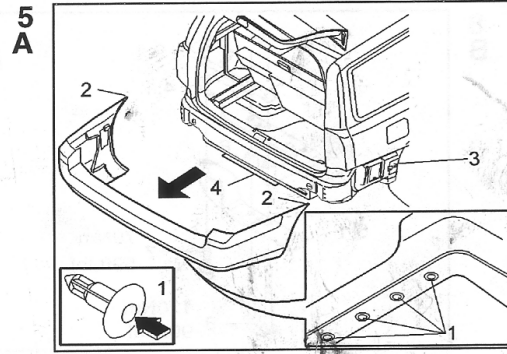

M8600494

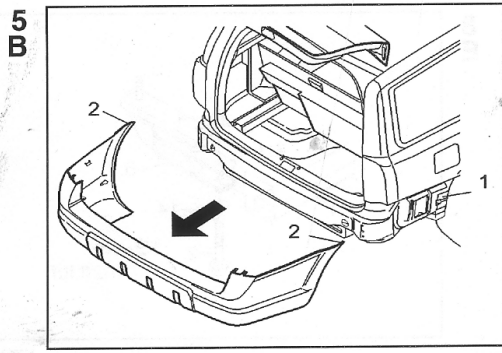

M8600566

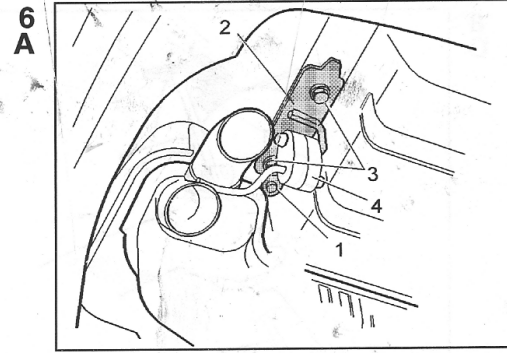

D2500722

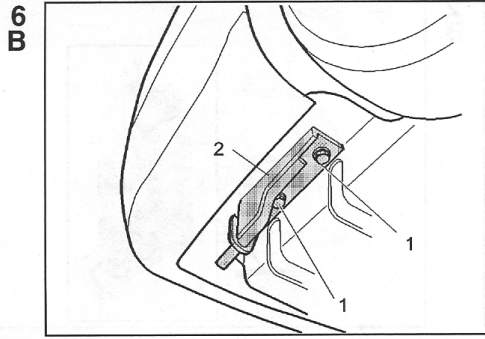

D8600247

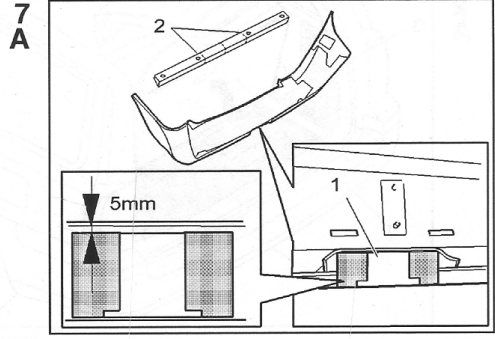

M8900556

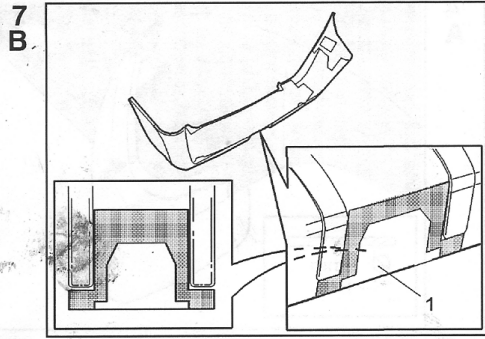

M8600271

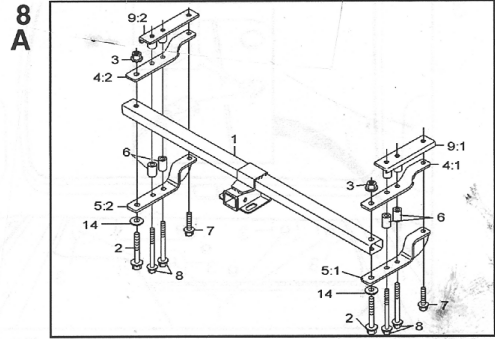

M8902601

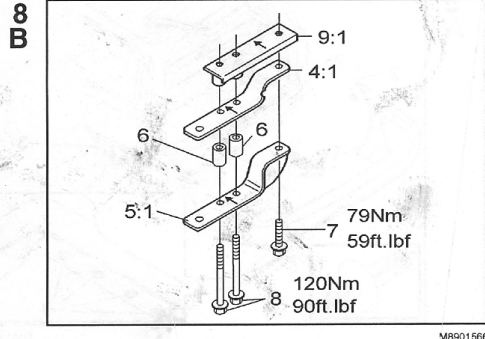

M8901566

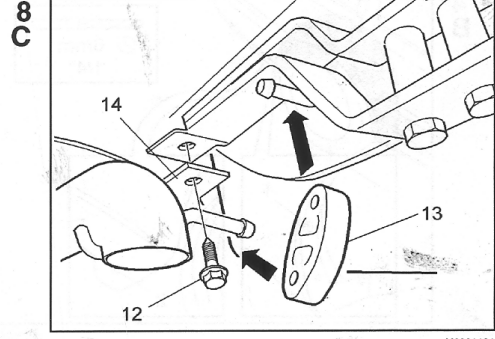

M8901484

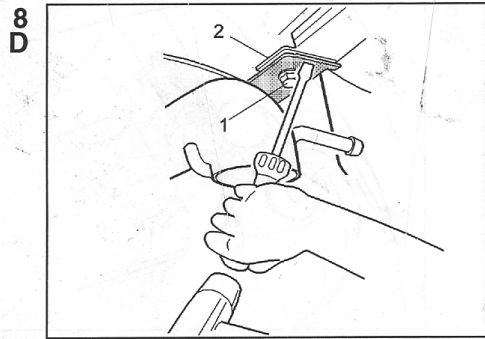

M8901546

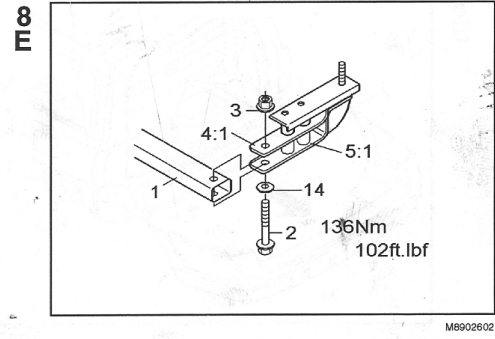

M8902602

10  
A

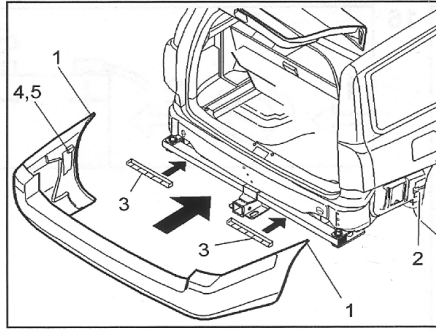

M8600867

10  
B

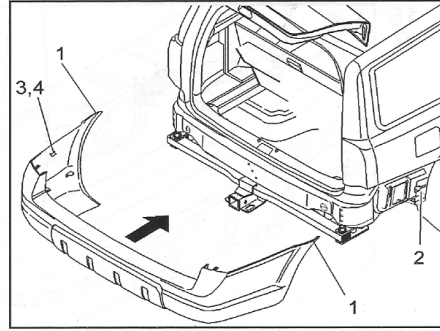

M8600870

11

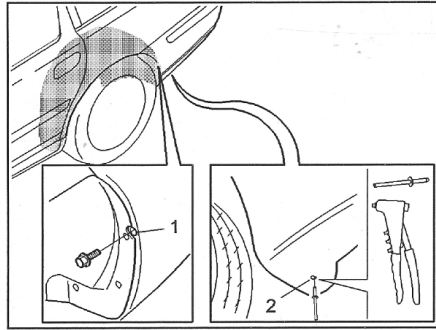

M8600491

12

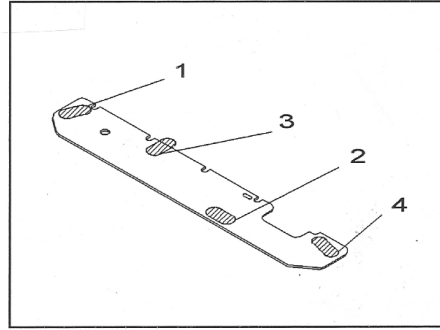

M8101296

13  
A

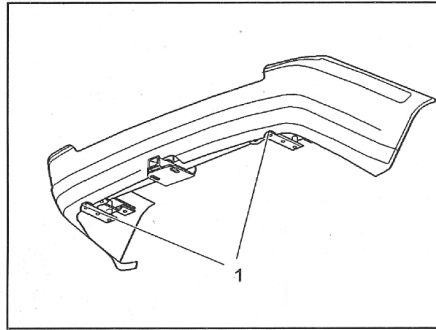

M8600868

13  
B

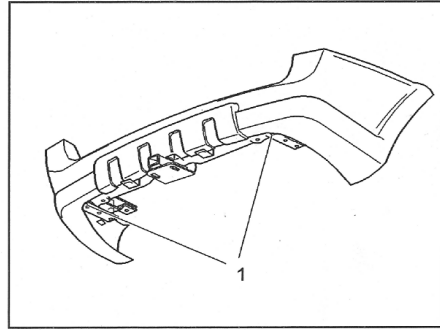

M8600871

14

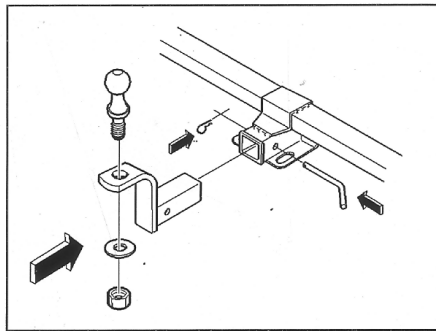

M8902868

15  
A

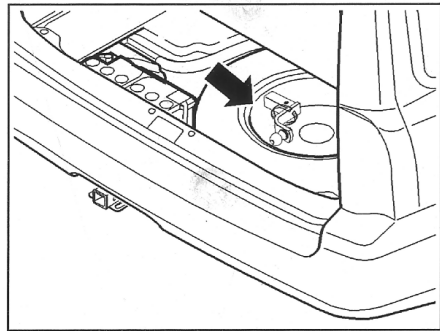

M8902559

15  
B

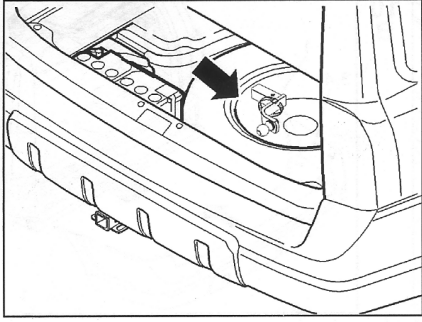

M8902424

16

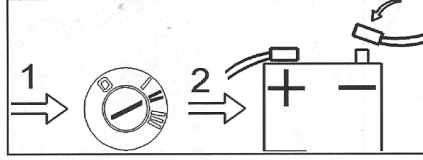

A8800137

## 15 Förvaring av kulhållare

**OBS!** Kulhållare, låsbult och låssprint köpes separat.

**Bild 15A** gäller V70

**Bild 15B** gäller V70 XC

- Ta bort kulhållaren och lägg den i den medföljande förvaringspåsen.
- Lägg påsen med kulhållaren i reservhjulet. Kulhållaren skall placeras som bilden visar
- Trä in remmen i de två närliggande hålen i fålgen och dra den runt kulhållaren.
- För in remmen i spännnet och dra fast tills kulhållaren är ordentligt fastspänd.

## 16 - Vrid tändningsnyckeln till läge II.

- Sätt tillbaka batteriets minusledning och täckåpor.
- Sätt tillbaka höger sidopanel och sätt dit clipsen.
- Sätt tillbaka förvaringsluckan och golvluckan.
- Sätt tillbaka panelen för bakstammen.
- Vik tillbaka golvmattan.
- Sätt dit täckåpan på dragbalken.

## 17 - Ta bort skyddstejpen på stötfångaren.

## English

### INTRODUCTION

- **NOTE!** Read through the entire text before carrying out any work.
- The front page gives the date of this edition and the edition it replaces
- The second page shows the tools needed for the installation and the contents of the installation kit
- The illustrations display the procedure in order of operation. The order of operation is repeated in the text section
- Cut out the text page in order to follow the illustrations and text at the same time.

### Tow bar

**NOTE!** The ball holder and ball with the accompanying components are not included in the tow hitch kit and must be purchased as a separate kits, see the list.

#### Kit contents:

- 1 Cross member
- 2 Screw M14 x 80 (x2)
- 3 Nut M14 (x2)
- 4 Upper bracket (x2)
- 5 Lower bracket (x2)
- 6 Sleeve (x4)
- 7 Screws M12 x 50 (x2)
- 8 Screw M12 x 130 (x4)
- 9 Reinforcement panel with sleeves (x2)
- 10 Locking bolt (purchased separately)
- 11 Strap (purchased separately)
- 12 Ball holder (purchased separately)
- 13 Ball (purchased separately)
- 14 Blind rivet (x12)
- 15 Nut M16 (purchased separately)
- 16 Washer (x2)
- 17 Locking washer 3/4" (purchased separately)
- 18 Rubber tab (x4)
- 19 Cotter pin (purchased separately)
- 20 Cover
- 21 Protective cover (purchased separately).

**Hint:** Type approval of the tow hitch is in the table on the second page.

**NOTE!** A new lining mat is required for cars manufactured up to week 13, 2000. The lining mats (P/N 8625515) for these cars are ordered separately.

**NOTE!** It is recommended that operations 5 and 10 are carried out by two people.

## Preparations

- 1 – Turn the ignition key to position 0  
– Remove the key from the ignition switch (does not apply to cars with automatic gearboxes).  
**NOTE! Wait at least five minutes before disassembling the connectors or removing other electrical equipment.**

### 2 Illustration 2A

- Lift up and remove the floor hatch (1)
- Lift up and remove the storage cover (2)
- Remove the side panel (3) on the left-hand side.

### Illustration 2B

- Remove the two nuts from the front edge of the battery holder. Remove the cover over the battery. Then unscrew the screw in the rear edge a few turns. Remove the holder
- Remove the battery cover
- Disconnect the battery negative lead
- Move or remove the battery to facilitate access.

### 3 Applies to cars with lining mats with four perforations

- Remove the perforated sections (3) from the lining mat.

### Applies to cars with lining mats with one perforation

- Remove the lining mat.

### Applies to all cars

- Remove the nuts (1) in the rear crossmember. This allows the bumper to be removed
- Separate the connector (2) for the antenna.

### 4 – Raise the car.

### Illustration 4A applies to cars with mudguards

- Remove the rear wheels
- Carefully drill out the rivets that hold the mudguard in place on both sides. Use a 6 mm (1/4") diameter drill bit
- Remove the mudguards.

### Illustration 4B applies to all cars

- Carefully drill out the rivets (2) underneath the bumper on both sides. Use a 6 mm (1/4") diameter drill bit
- Remove the screw (1) holding the fender liner for the bumper cover on both sides.

**NOTE! Do not damage any of the plastic components.**

### 5 Illustration 5A applies to the V70

- **Only applies if the car has clips:** Remove the clips (1) at the bottom of the bumper cover (press in the centre of the clips until they click). Remove the clips. The clips will be reused
- Pull the bumper backwards slightly. Bend out the sides (2) so that they detach from the mounting (3). Then pull the bumper backwards until it detaches completely
- Place the bumper on a clean underlay that will not damage the paint
- **Only applies if the car is equipped with mouldings:** Carefully remove the moulding (4) from the expander clips.

### Illustration 5B applies to the V70 XC

- Pull the bumper backwards slightly. Bend out the sides (2) so that they detach from the mounting (1). Then pull the bumper backwards until it detaches completely
- Place the bumper on a clean underlay that will not damage the paint.

### 6 Illustration 6A

- Remove the rivet (1) on the bracket (2) for the silencer. Use cutting nippers
- Remove the screws (3) on the bracket
- Remove the bracket: Remove the rubber mountings (4). The bracket will not be used again.

### Illustration 6B

- Remove the screws (1). Remove the bracket (2). The bracket will not be used again.

### 7 Illustration 7A applies to the V70

### Illustration 7B applies to the V70 XC

- Install masking tape on the outside of the bumper to avoid damage from the saw. Leave the masking tape in place throughout the installation procedure
- Tape the template to the inside of the bumper as illustrated
- Cut out the area (1) as illustrated
- After cutting, file down the edges
- **Only applies if the car is equipped with mouldings:** Also cut out the moulding following the instructions (2).



## Installing the tow bar

8

### Illustration 8A

Illustration 8A shows how the tow bar and its components are assembled and installed on the car body.

### Illustration 8B

Illustration 8B shows how the brackets are assembled with the body.

### Illustration 8C

Illustration 8C shows the installation of the rubber mounting for the exhaust system.

### Illustration 8D

Illustration 8D displays how to bend the heat deflector plate.

### Illustration 8E

Illustration 8E shows how the member is assembled with the brackets.

- Clean away any underseal and dirt from the surfaces between the tow hitch and the bodywork.

### Carry out the operation according to illustration 8B

- (The right-hand side is displayed.) Install the screws (7, 8) from underneath the brackets (4:1, 5:1, 9:1), including the spacers (6). Tighten by hand. The arrows on the brackets (4:1, 5:1, 9:1) must point towards the centre of the car. Repeat the operation on the left-hand side.

### Carry out according to illustrations 8C and 8D

- Install the heat deflector plate (14) using the screw (12)
- Loosely screw the heat deflector plate into place on the member (2) using the screw (1)
- Bend the heat deflector plate using a screwdriver
- Fully screw in the screw
- Reinstall the rubber mounting (13) for the silencer. Use soap to facilitate installation.

### Carry out the operation according to illustration 8E

- Insert the member (1) between the brackets (4, 5) on the left and right hand sides. Centre the holes
- Install the screws (2) and the washers (14) from the underneath of the brackets (5). Install the nuts (3) from above the bracket. Do not tighten
- Check that the distance between the member (1) and the spare wheel well is 10 mm (25/64"). Centre the tow hitch to the car.

**Carry out the operation according to illustration 8B**

- (The right-hand side then displays — the holes when on the left-hand side.) Tighten the screw (7). Tighten to **79 Nm (59 lbf.ft)**. Tighten the screws (8). Tighten to **120 Nm (90 lbf ft)**. Repeat the operation on the left-hand side.

**Carry out the operation according to illustration 8E**

- Tighten the screws (2) and the nuts (3). Tighten to **136 Nm (102 lbf ft)** on both sides.

**Carry out the operation according to illustration 8B**

- Wait at least five minutes, so that the joint has time to set. Then tighten the screws (8) on both sides, a quarter turn (angle tighten 90°).

**NOTE! Torque tightened screws that have been removed must not be reused.**

- 9 – Underseal the car.

**Finishing work**

**10 Illustration 10A applies to the V70**

- **Only applies if the car is equipped with mouldings:** Reinstall the mouldings (3) on the expander clips. Press the mouldings into place
- Reinstall the guide lugs (4) and the clips (5) if they have been removed
- Reinstall the bumper by pressing it forwards. Ensure that the four screws protruding from the bumper align with the holes in the car
- Before the bumper is completely installed, slide the top edge (1) into the grooves. Then slide the bumper fully in
- Check that the guide lug (4) and clip (5) are centred with the hole in the fender liner.

**Illustration 10B applies to the V70 XC**

- Reinstall the guide lugs (3) and the clips (4) if they have been removed
- Reinstall the bumper by pressing it forwards. Ensure that the four screws protruding from the bumper align with the holes in the car
- Before the bumper is completely installed, slide the top edge (1) into the grooves. Then slide the bumper fully in
- Check that the guide lug (3) and clip (4) are centred with the hole (2) in the fender liner.

- 11 – Tighten the screw (1) on both sides
- Rivet (2) the bumper into place as illustrated
  - **Only applies if the car is equipped with clips and mouldings:** Reinstall the clips underneath the bumper. This is to lower the bumper towards the mouldings, (see point 5). Ensure that the clip locks are in the normal position

- Reinstall the nuts. Tighten to **18 Nm (14 lbf ft)**.(see point 3)

- Connect the antenna connector.

**Applies to cars with rear mudguards**

- Rivet the mudguard into place (see point 4)
- Reinstall the wheels. Tighten the screws crosswise. Tighten to **140 Nm (104 lbf ft)**.

**12 Applies to cars with lining mats with four perforations, according to point 3**

Install the rubber tabs (from the kit) over the four installed screws as follows:

- Align the rubber tabs (1) edge to edge with the lining mat
- Compress the rubber tab (2) slightly to align in the cut out
- Align the rubber tab (3) so that the lower edge is positioned edge to edge with the lining mat. Cut off the section protruding over the lining mat. (Do not cut off an excessive amount).

**Applies to cars with lining mats with one perforation, according to point 3**

- Install a new lining mat.

**13 Illustration 13A applies to the V70**

- If necessary, cut away the area (1) around the screw heads so that the screws are accessible.

**Illustration 13B applies to the V70 XC**

**14 Securing the ball holder**

**NOTE! Ball holder and ball purchased separately.**

- Remove the cover from the tow bar
- Slide the ball holder into the tow bar. Slide until the holes in the ball holder and tow bar correspond
- Slide the locking bolt into the hole
- Lock the other side using the cotter pin
- Position the ball in the hole on the ball holder
- Install the washer and nut. Tighten to **244 Nm (176.5 lbf.ft)**.

## 15 Storing the ball holder

**NOTE!** The ball holder, locking bolt and cotter pin are purchased separately.

Illustration 15A applies to the V70

Illustration 15B applies to the V70 XC

- Remove the ball holder. Place the ball holder in the supplied storage bag
- Place the bag with the ball holder in the spare wheel. The ball holder must be positioned as illustrated
- Thread the strap through the two nearest holes in the wheel and around the ball holder
- Insert the strap into the tensioner. Tighten the strap until the ball holder is secured.

- 16
- Turn the ignition key to position II
  - Reconnect the battery negative lead. Reinstall the covers
  - Reinstall the right side panel. Install the clips
  - Reinstall the storage cover and the floor hatch
  - Reinstall the panel for the rear crossmember
  - Fold back the carpet
  - Install the cover on the tow bar.

- 17
- Remove the masking tape from the bumper.

## FRANÇAIS

### INTRODUCTION

- **REMARQUE!** Lisez le texte dans sa totalité avant de procéder à toute intervention.
- La page de garde indique la date de cette édition et l'édition qu'elle remplace
- La seconde page détaille l'ensemble des outils nécessaires à la pose ainsi que le contenu du kit d'installation
- Les illustrations indiquent, dans un ordre chronologique, la procédure à suivre. Cet ordre est répété dans la section regroupant les textes explicatifs
- Découpez la page texte afin de suivre illustrations et texte en même temps.

### Barre de remorquage

**ATTENTION!** Le support de boule et la boule de remorquage et leurs composants sont livrés en kits individuels et ne sont pas inclus dans ce kit. Ces éléments doivent être achetés séparément, reportez-vous à la liste.

#### Contenu du kit:

- 1 Barre transversale
- 2 Vis M14 x 80 (x2)
- 3 Ecrou M14 (x2)
- 4 Support supérieur (x2)
- 5 Support inférieur (x2)
- 6 Manchon (x4)
- 7 Vis M12 x 50 (x2)
- 8 Vis M12 x 130 (x4)
- 9 Panneau de renforcement avec manchons (x2)
- 10 Boulon d'arrêt (à acheter séparément)
- 11 Sangle (à acheter séparément)
- 12 Support de boule de remorquage (à acheter séparément)
- 13 Boule de remorquage (à acheter séparément)
- 14 Faux rivet (x12)
- 15 Ecrou M16 (à acheter séparément)
- 16 Rondelle (x2)
- 17 Boulon d'arrêt 3/4" (à acheter séparément)
- 18 Patte en caoutchouc (x4)
- 19 Clavette d'arrêt (à acheter séparément)
- 20 Protection
- 21 Bâche de protection (à acheter séparément).

**Conseil:** Le numéro d'homologation du crochet de remorquage se trouve dans le tableau à la page numéro deux.

**ATTENTION!** Un nouveau tapis de garniture est nécessaire pour les voitures dont la date de fabrication est antérieure à la semaine 13 de l'an 2000. Les tapis de garniture (N/P 8625515) prévus pour ces voitures doivent être commandés séparément.

**ATTENTION!** Nous vous recommandons d'effectuer les interventions 5 et 10 à deux.

